

Rainwater Outlet

Step by step guide on installing a rainwater outlet into your next EPDM project.

1

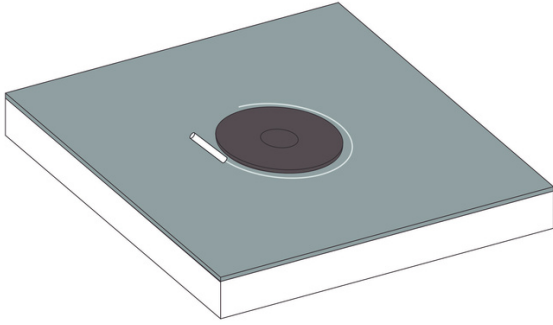

Step 1

Place rainwater outlet through the pre-cut hole and mark around it using a crayon or similar.

2

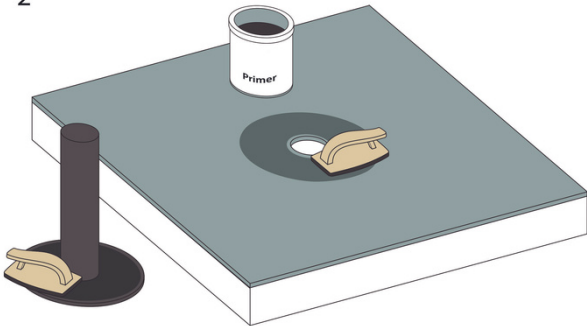

Step 2

Prime the underside of the rainwater outlet and 1 cm beyond the marked area on the rubber using a quick scrubber pad and handle. Allow both surfaces to dry.

3

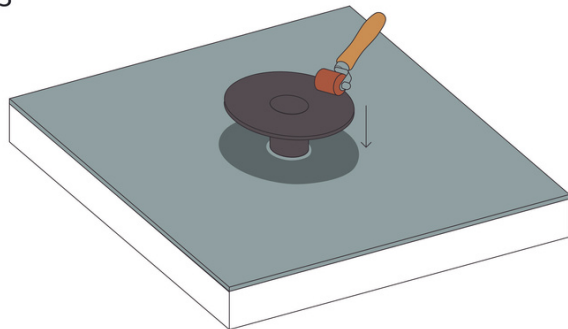

Step 3

Mate the surfaces together and compress with silicone roller.

4

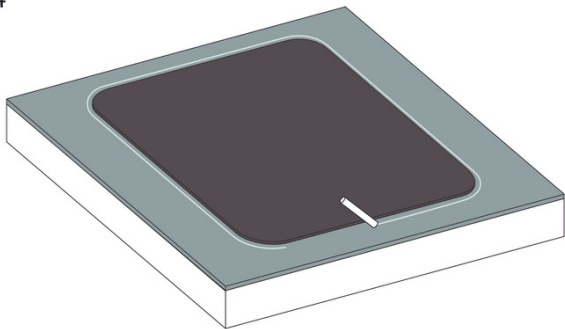

Step 4

Round the corners of the 12" formflash (Rainwater flashing kit) with scissors and neatly position over outlet. Mark the perimeter with crayon.

5

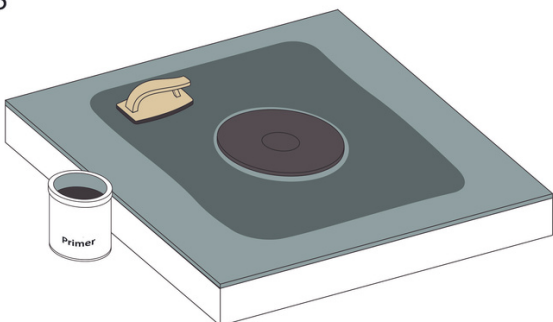

Step 5

Prime the rubber and outlet using the quick scrubber pad and handle and extend primer beyond the crayon line by 2cm.

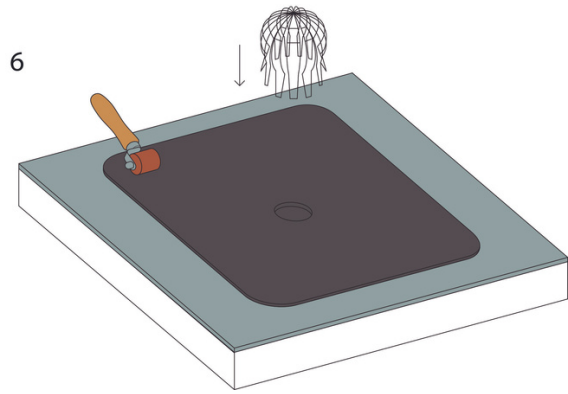

Step 6

Once touch dry, neatly position the 12" Flashing tape and carefully remove the backing paper. Roller firmly in place and use a sharp blade to carefully cut out the hole.